



Call for Exhibitors

Dear Sir or Madam,

The **2010 ISMA Conference on Noise and Vibration Engineering** will be held from September 20th till 22th in Leuven, Belgium. It is the 24th in a series of annual courses and biennial conferences on **structural dynamics, modal analysis and noise and vibration engineering**, organised by the Department of Mechanical Engineering of the Katholieke Universiteit Leuven. The conference will provide a forum for engineers, researchers and other professionals active in the field of modelling, analysing, testing and improving the noise and vibration characteristics of mechanical systems and civil structures. ISMA combines expertise in the noise and vibration fields by stressing common measurement, modelling, analysis and control technologies.

The previous ISMA conference in 2008 was very successful: approximately 600 people (40% from industry, 60% from universities) from all around the world attended the conference, while 13 companies presented their products at the parallel ISMA exhibition.

During the conference, **an exhibition of related equipment** (data acquisition systems, transducers, software packages,...) will be organised. We are convinced that this exhibition presents a unique opportunity for hardware and software vendors to meet large numbers of international noise and vibration control practitioners. The exhibition will take place in the entrance hall of the 'college De Valk', where the conference will be held. A time schedule for setting up, installing and removing the booths is included.

You will find enclosed a subscription form for exhibitors and a layout of the exhibition room, indicating the locations of the different booths and a list of the rental fees (VAT exclusive). The fee includes: separation panels, furniture (2 tables, 3 chairs, 3 spots), electricity (220V, 50 Hz, max 16A), wireless Internet and conference participation including the CD-ROM proceedings for one delegate. Equipment insurance is not included. Optionally, two adjacent booths can be combined to one larger booth. Since space is limited, the allocation of the booths will be made on a first come, first served basis.

The exhibition details with the list of exhibitors and the location of their booth will be announced on the conference website and included in the conference program brochure that will be handed out to all participants.

Please do not hesitate to contact us if you have any questions or if you want further information. We hope your company will not fail on this opportunity and look forward to meeting you in Leuven,

Sincerely yours,

Prof. Paul Sas
Conference chairman



Call for Exhibitors

Company name:

Company address:

Billing address:

TAX/VAT number:

Name contact person:

E-mail contact person:

Telephone: Fax:

Conference participant:

Other exhibitor(s) name(s):

Preferred locations: 1st choice fee €

2nd choice fee €

3rd choice fee €

We wish to order tickets for the conference dinner on Tuesday September 21th, 2010.

(Fee: 60,00 € per ticket)

Additional comments:

.....
.....
.....

Date: / / Signature:

Please return this form **before 1st of May 2010** to:

William Jacobs
Exhibition manager
K.U.Leuven, Dept. of Mech. Eng., Division of PMA,
Celestijnenlaan 300B
B-3001 Heverlee, Belgium
E-mail : william.jacobs@mech.kuleuven.be
Telephone: +32 16 32 86 03 - Fax: +32 16 32 29 87

Temporary exhibition layout (the final exhibition layout will be sent beginning of July 2010):

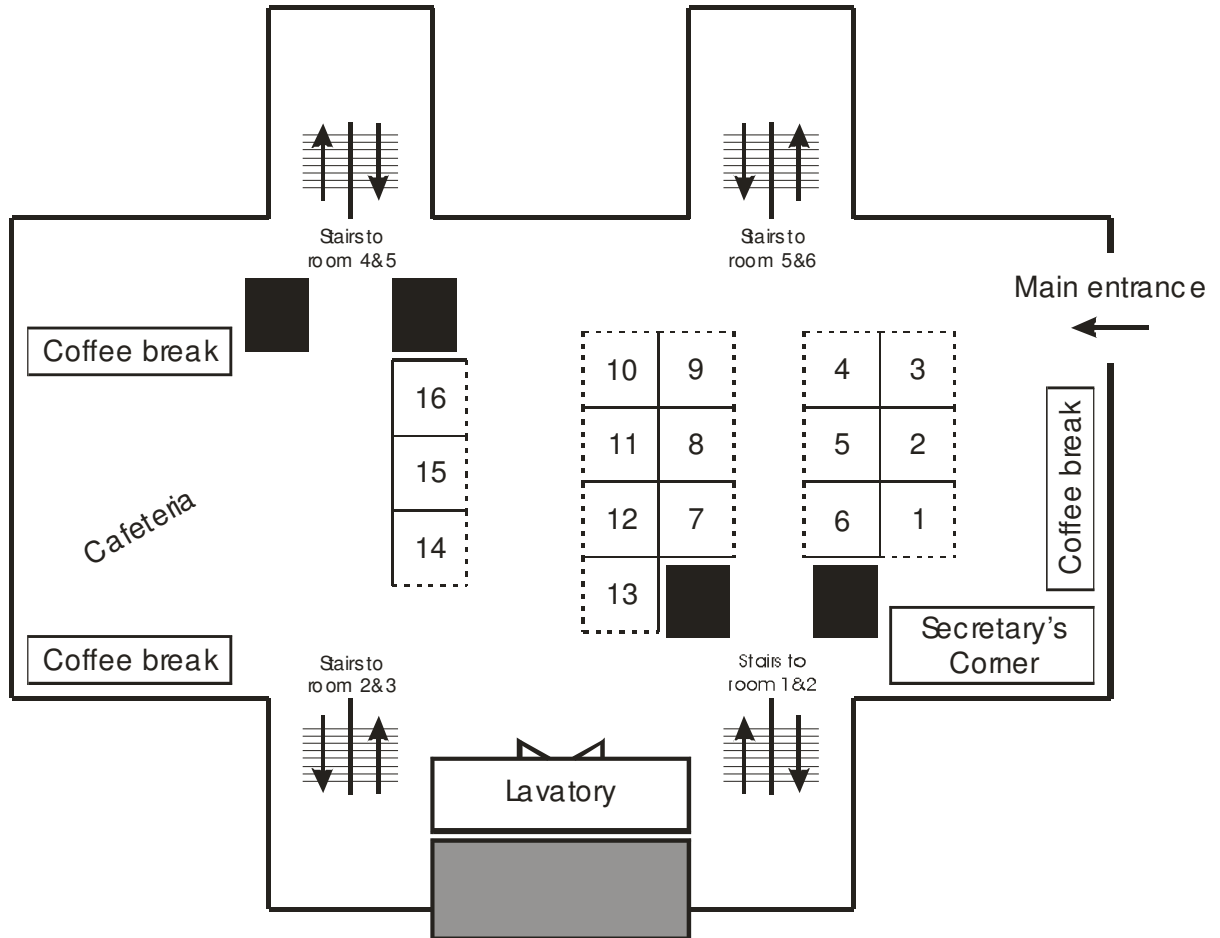

| Booth Nr. | Dimensions | Area | Fee | Booth Nr. | Dimensions | Area | Fee |
|-----------|------------|------------------|--------|-----------|------------|------------------|--------|
| 1 | 3 m x 3 m | 9 m ² | € 2000 | 9 | 3 m x 3 m | 9 m ² | € 2000 |
| 2 | 3 m x 3 m | 9 m ² | € 2000 | 10 | 3 m x 3 m | 9 m ² | € 2000 |
| 3 | 3 m x 3 m | 9 m ² | € 2000 | 11 | 3 m x 3 m | 9 m ² | € 2000 |
| 4 | 3 m x 3 m | 9 m ² | € 2000 | 12 | 3 m x 3 m | 9 m ² | € 2000 |
| 5 | 3 m x 3 m | 9 m ² | € 2000 | 13 | 3 m x 3 m | 9 m ² | € 2000 |
| 6 | 3 m x 3 m | 9 m ² | € 2000 | 14 | 3 m x 3 m | 9 m ² | € 2000 |
| 7 | 3 m x 3 m | 9 m ² | € 2000 | 15 | 3 m x 3 m | 9 m ² | € 2000 |
| 8 | 3 m x 3 m | 9 m ² | € 2000 | 16 | 3 m x 3 m | 9 m ² | € 2000 |



Call for Exhibitors

| Event | Date | Time |
|----------------------------|------------|----------------|
| Installation of the booths | 20/09/2010 | 08h00 – 12h00 |
| | 20/09/2010 | 13h00 – 18h00 |
| Opening hours conference | 21/09/2010 | 09h00 – 18h00 |
| | 22/09/2010 | 09h00 – 14h00 |
| Removal of the booths | 22/09/2010 | 14h00 – 17h00* |

* All material has to be removed from the exhibition room by Wednesday September 22th 17h00.